

Signs

2 Signs

AHLMANN

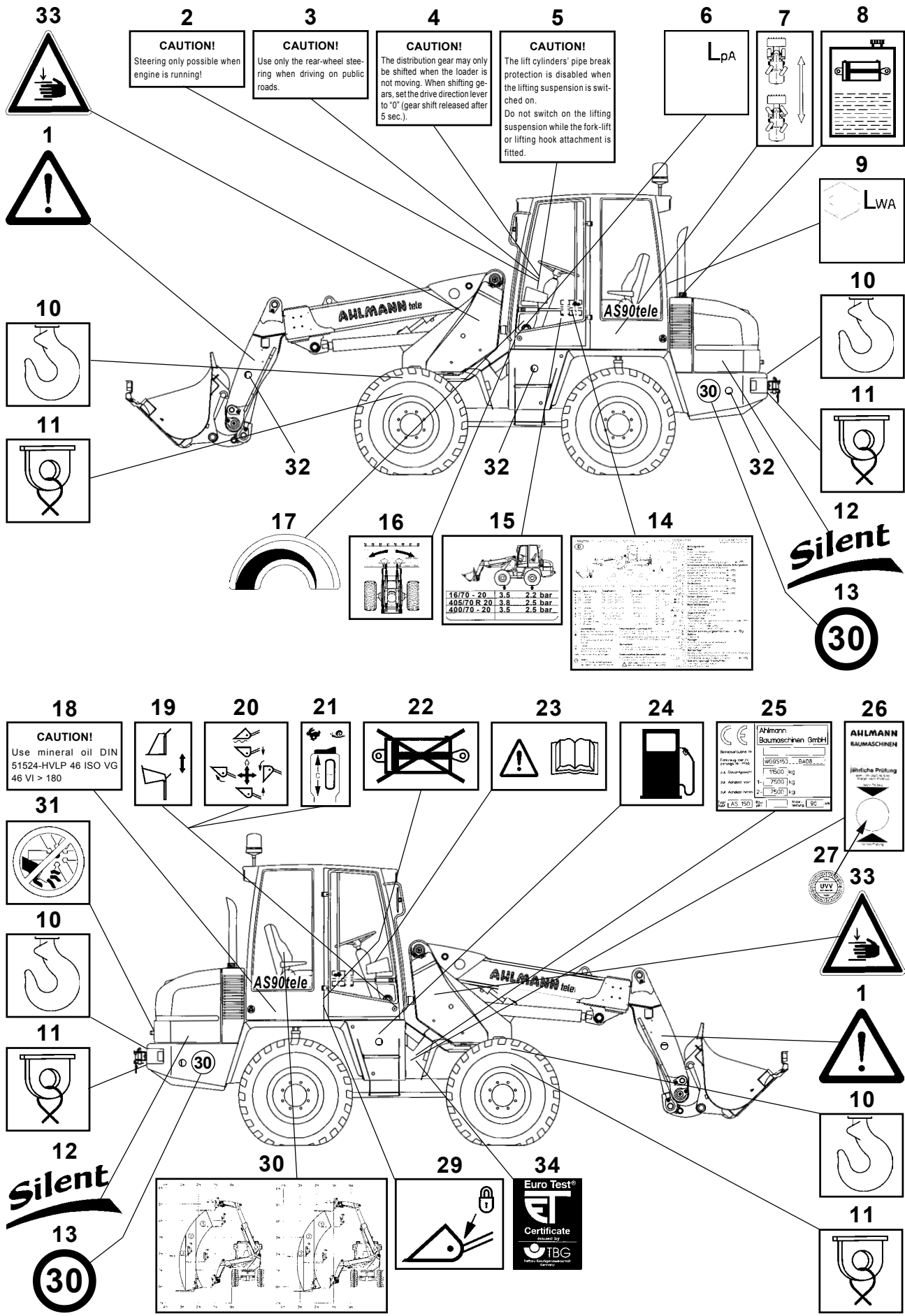

- 1 Symbol: Stay out of the danger zone
- 2 Sign: **CAUTION!** - Steering only possible when engine is running!
- 3 Sign: **CAUTION!** -Use only rear-wheel steering when driving on public roads.
- 4 Sign: **» Only for fast loaders - 30 km/h «**
CAUTION!
The distribution gear may only be shifted when the loader is not moving. When shifting gears, set the drive direction lever to "0" (gear shift released after 5 sec.).
- 5 Sign: **» Only for loaders with pipe break protection «**
CAUTION!
The lift cylinders' pipe break protection is disabled when the lifting suspension is switched on. Do not switch on the lifting suspension while the fork-lift or lifting hook attachment is fitted.
- 6 Sign: Acoustic power level (sect. 11.17)
- 7 Symbol: Steering type switching (4-9/2)
rear-wheel/four-wheel steering
- 8 Symbol: Hydraulic oil tank
- 9 Sign: Sound power level (sect. 11.17)
- 10 Symbol: Lifting points for transportation by crane
- 11 Symbol: Fixing eyes for towing and lashing
- 12 Sign: Lettering "Low-noise construction machine"
- 13 Sign: Maximum speed
- 14 Sign: Maintenance schedule
- 15 Sign: Tyre pressure
- 16 Symbol: Swivelling
- 17 Symbol: Heater
- 18 Sign: Use mineral oil DIN 51524-HVLP 46 ISO VG 46 VI > 180
(to the right next to the driver's seat on the maintenance flap)
- 19 Symbol: Hand lever for auxiliary hydraulics (4-10/2)
 - Quick-change device
 - Hand lever forward - lock
 - Hand lever to the rear - unlock
 - Multi-purpose bucket
 - Hand lever forward - close
 - Hand lever to the rear - open
- 20 Symbol: Hand lever for working hydraulics (4-10/9)
 - Telescope arm
 - Hand lever forward - lower
 - Hand lever to the rear - raise
 - Hand lever forward beyond its pressure point - Floating position
 - Quick-change device
 - Hand lever to the left - tilt up
 - Hand lever to the right - dump
 - Bucket / fork-lift attachment / load hook
 - Hand lever to the left - tilt up
 - Hand lever to the right - dump
- 21 Symbol: Hydraulic drive stages (4-10/13)
 - Hare symbol - fast
 - Snail symbol - slow
 - Drive direction - forward
 - 0
 - reverse
- 22 Symbol: Ball block valve for working/auxiliary hydraulics closed
- 23 Symbol: Read and observe the operating instructions before commissioning.
Make sure that all other users have read the safety instructions!
- 24 Symbol: Fuel tank
- 25 Machine type label (includes the identification number of the vehicle)
- 26 Sign: Annual inspection as per UVV
- 27 Sign: UVV badge
- 28 Omitted
- 29 Symbol: Quick-change device locked
- 30 Sign: Fork-lift attachment load diagram
- 31 Symbol: Open only when the engine is not running
- 32 Lateral reflector on both sides of the machine
- 33 Symbol: Beware of hand injuries
- 34 Euro Test Certificate