

# Signs

## 2 Signs

**Mecalac**

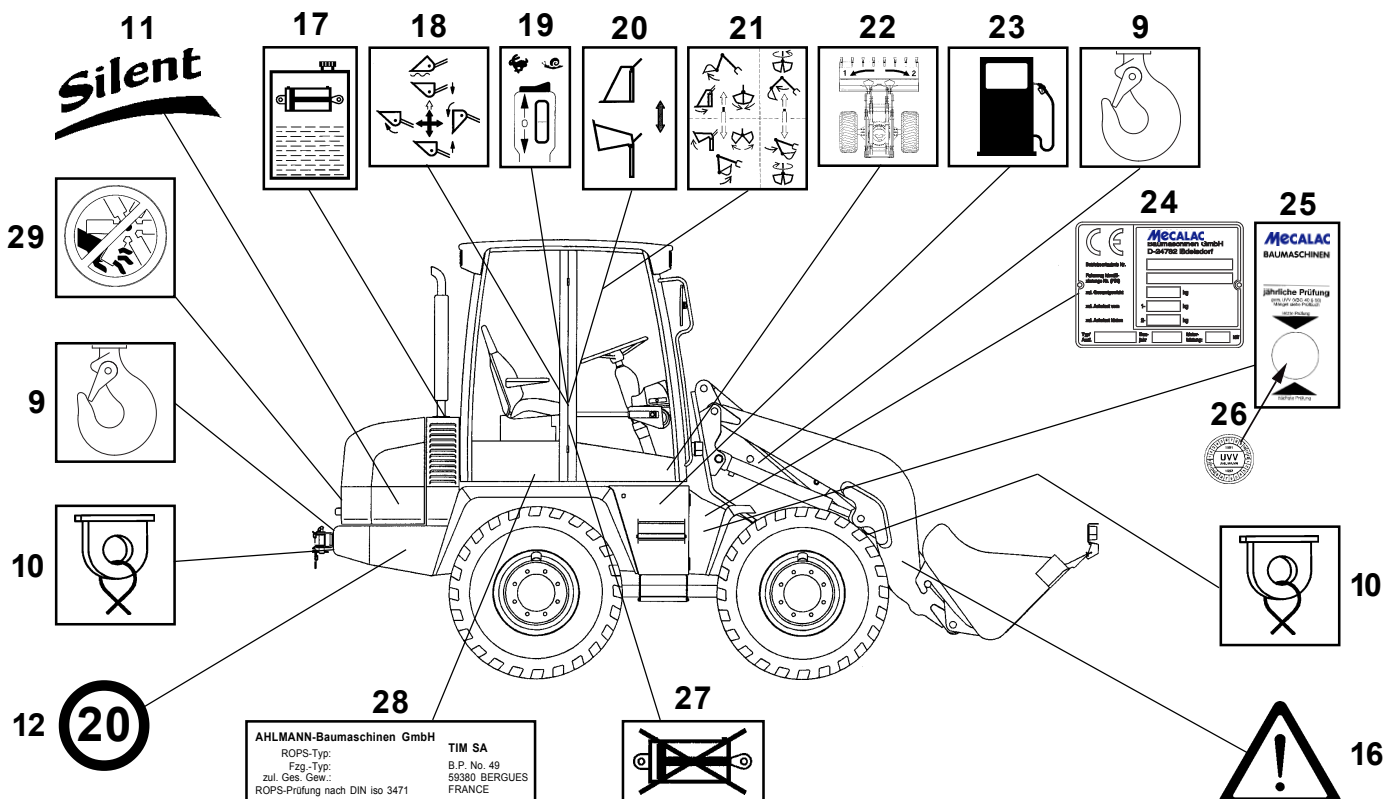
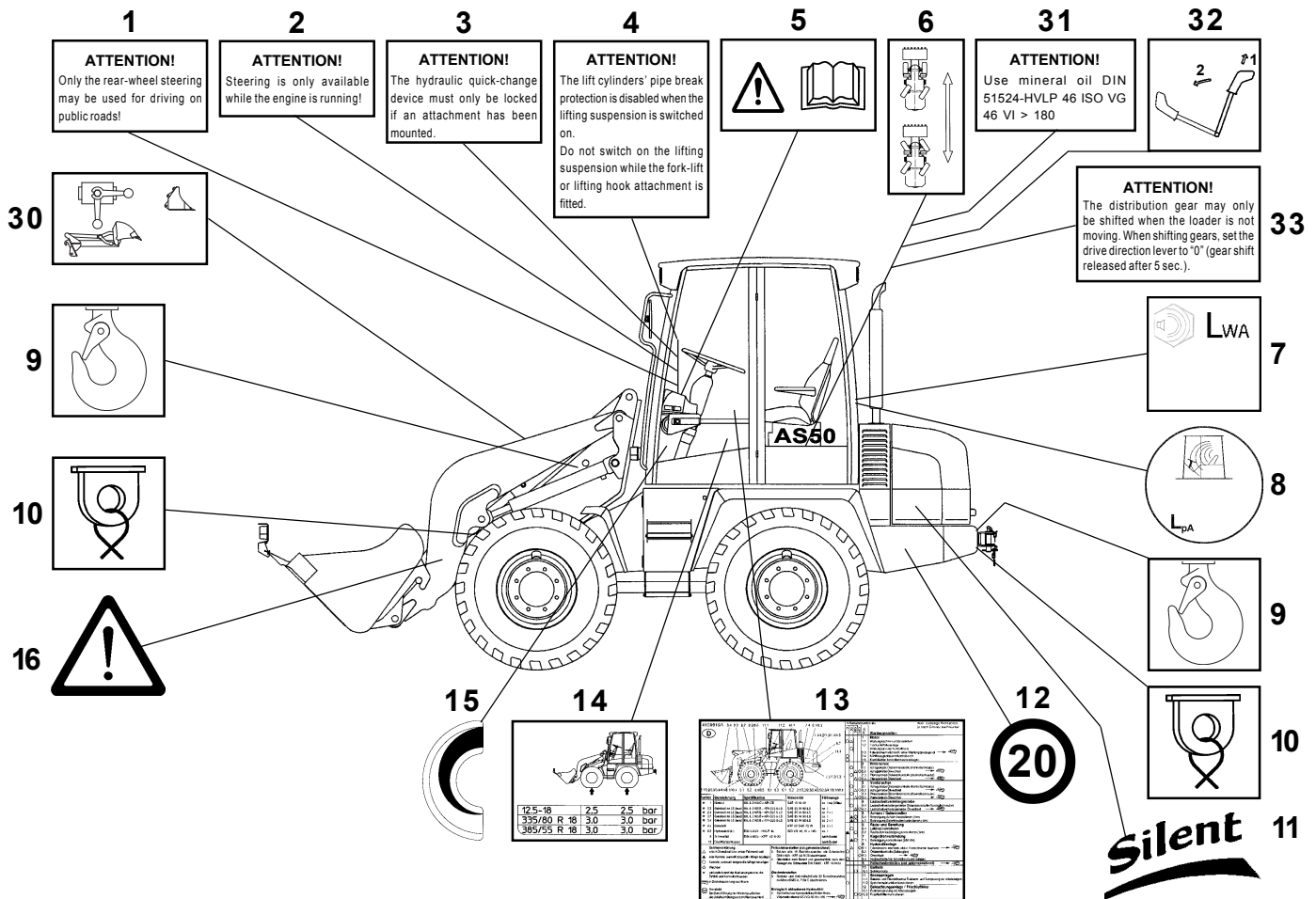

- 1 Sign: **ATTENTION!** - Only the rear-wheel steering may be used for driving on public roads!
- 2 Sign: **ATTENTION!** - Steering is only available while the engine is running!
- 3 Sign: **ATTENTION!** - The hydraulic quick-change device must only be locked if an attachment has been mounted.
- 4 Sign: **» Only for loaders with pipe break protection «**  
**ATTENTION!** - The lift cylinders' pipe break protection is disabled when the lifting suspension is switched on.  
 Do not switch on the lifting suspension while the fork-lift or lifting hook attachment is fitted.
- 5 Symbol: Read and implement instructions in manual before commissioning.  
 Ensure that all other users are aware of safety precautions!
- 6 Symbol: Switch steering type (4-6/3)  
 Rear wheel/Four wheel
- 7 Sign: Noise level (Chp. 11.17)
- 8 Sign: Accoustic pressure (Chp. 11.17)
- 9 Symbol: Lifting hook
- 10 Symbol: Lashing points
- 11 Sign: Low noise emission equipment
- 12 Sign: Max. speed
- 13 Sign: Maintenance plan
- 14 Sign: Tire pressure
- 15 Symbol: Heater
- 16 Symbol: Dangerous area, keep clear
- 17 Symbol: Hydraulic oil tank
- 18 Symbol: Manual lever for main hydraulics (4-7/2)
- 19 Symbol: Hydraulic gear shift (4-7/1 and 4-7/3)  
 Hare symbol - road  
 Snail symbol - field  
 Direction - forwards  
                   - 0  
                   - reverse
- 20 Symbol: Manual lever for auxilliary hydraulics (4-7/6)
- 21 Symbol: **» Only for loaders with second auxiliary hydraulics circuit «**  
 Manual lever for auxilliary hydraulics (4-7/6)
- 22 Symbol: Swivel joint
- 23 Symbol: Fuel tank
- 24 Type plate: Machine (includes vehicle ID number)
- 25 Sign: Annual inspection to TC standards
- 26 Sign: TC plaque
- 27 Symbol: Stop valve for main/auxilliary hydraulics - closed
- 28 Type plate: Operator's cabin
- 29 Symbol: Do not open while engine is running
- 30 Symbol: **» Only for loaders with front-end excavator «**  
 Switching attachment (at the tip cylinder)
- 31 Sign: Use mineral oil DIN 51524-HVLP 46 ISO VG 46 VI > 180
- 32 Symbol: **» Only for loaders with second auxiliary hydraulics circuit «**  
 Pilot valve fold-away
- 33 Sign: **» Only for fast loaders «**  
**ATTENTION!** - The distribution gear may only be shifted when the loader is not moving.  
 When shifting gears, set the drive direction lever to "0" (gear shift released after 5 sec.).

