

Signs

2 Signs

Mecalac

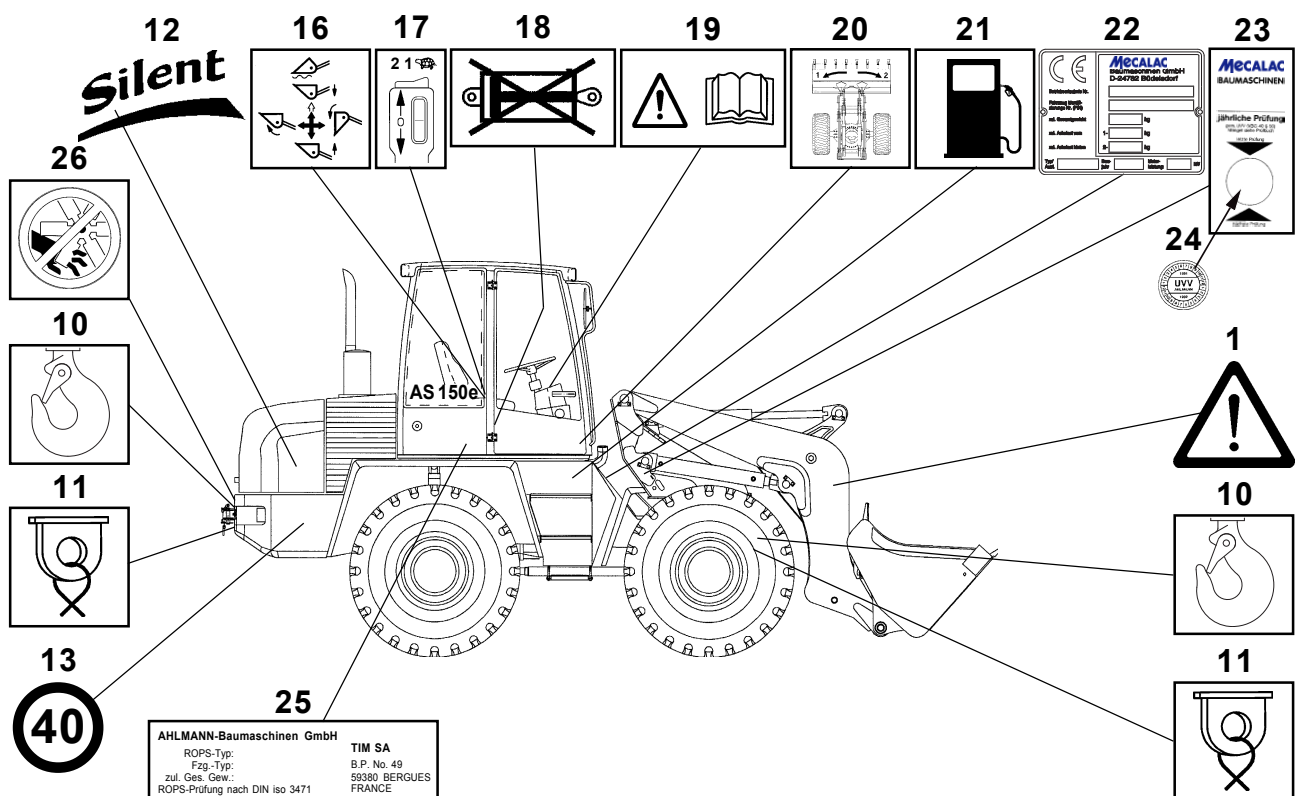
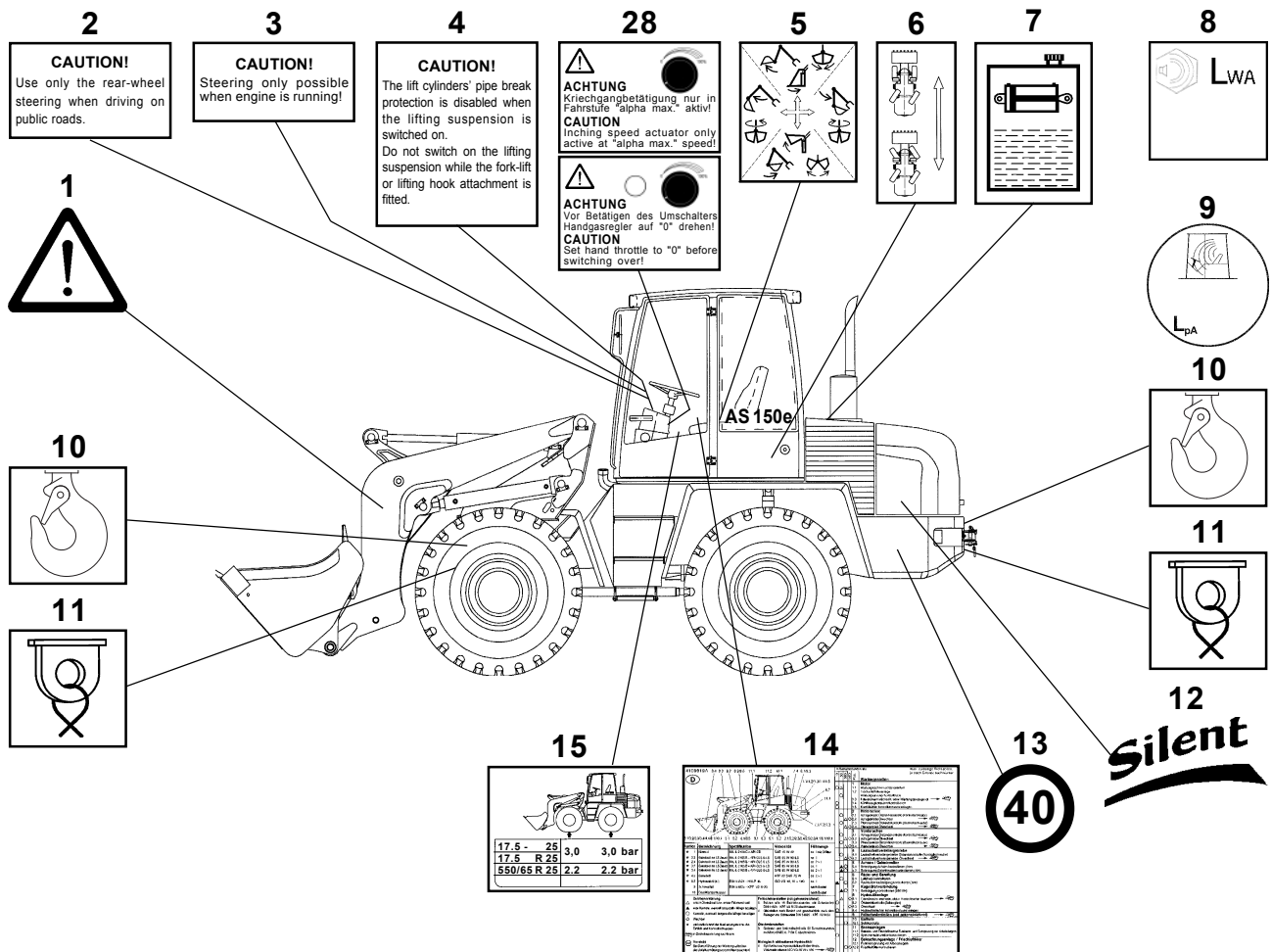

- 1 Symbol: Stay out of the danger zone
- 2 Sign: **CAUTION!** -Use only rear-wheel steering when driving on public roads.
- 3 Sign: **CAUTION!** - Steering only possible when engine is running!
- 4 Sign: **» Only for loaders with pipe break protection «**
CAUTION!
The lift cylinders' pipe break protection is disabled when the lifting suspension is switched on.
Do not switch on the lifting suspension while the fork-lift or lifting hook attachment is fitted.
- 5 Symbol: Hand lever for auxiliary hydraulics (4-6/5) » to the left of the seat «
- 6 Symbol: Steering type switching (4-6/4)
rear-wheel/four-wheel steering
- 7 Symbol: Hydraulic oil tank
- 8 Sign: Sound power level (sect. 11.17)
- 9 Sign: Acoustic power level (sect. 11.17)
- 10 Symbol: Lifting hook
- 11 Symbol: Lashing eyes
- 12 Sign: Lettering "Low-noise construction machine"
- 13 Sign: Maximum speed
- 14 Sign: Maintenance schedule
- 15 Sign: Tyre pressure
- 16 Symbol: Hand lever for working hydraulics (4-7/2)
- 17 Symbol: Gear shift - 2nd gear:
 - 1st gear:
 - Alpha max. (turtle symbol)
- 18 Symbol: Ball block valve for working/auxiliary hydraulics closed
- 19 Symbol: Read and observe the operating instructions before commissioning.
Make sure that all other users have read the safety instructions!
- 20 Symbol: Swivelling
- 21 Symbol: Fuel tank
- 22 Machine type label (includes the identification number of the vehicle)
- 23 Sign: Annual inspection as per UVV
- 24 Sign: UVV badge
- 25 Type label: Driver's cab
- 26 Symbol: Open only when the engine is not running
- 27 free
- 28 Sign: **CAUTION** - Inching speed actuator only active at "alpha max." speed!
Sign: **CAUTION** - Set hand throttle to "0" before switching over! (Option)

